

SLIMLINE STORAGE CABINET ASSEMBLY INSTRUCTIONS

General Instructions

1. Check material received against the packing list. Check the number of packages received and then check the contents of each package.
2. Check the material received for damage. If damage has occurred, secure a “damage notation” from the carrier
3. Identify each part as it is unpacked and put like parts together as close as possible to the working area where they are to be assembled.
4. Be careful to use the correct hardware as specified in the assembly instructions.

CAUTION

In the interest of safety, cabinets should be securely anchored to the floor and/or wall to prevent tipping.
Handle all components carefully and wear work gloves when assembling cabinets as some edges may be sharp.
Install all units plumb and tighten all hardware securely.
Retain instructions for future reference.



866-566-0500
info@Hallowell-List.com
www.Hallowell-List.com

CABINET PARTS

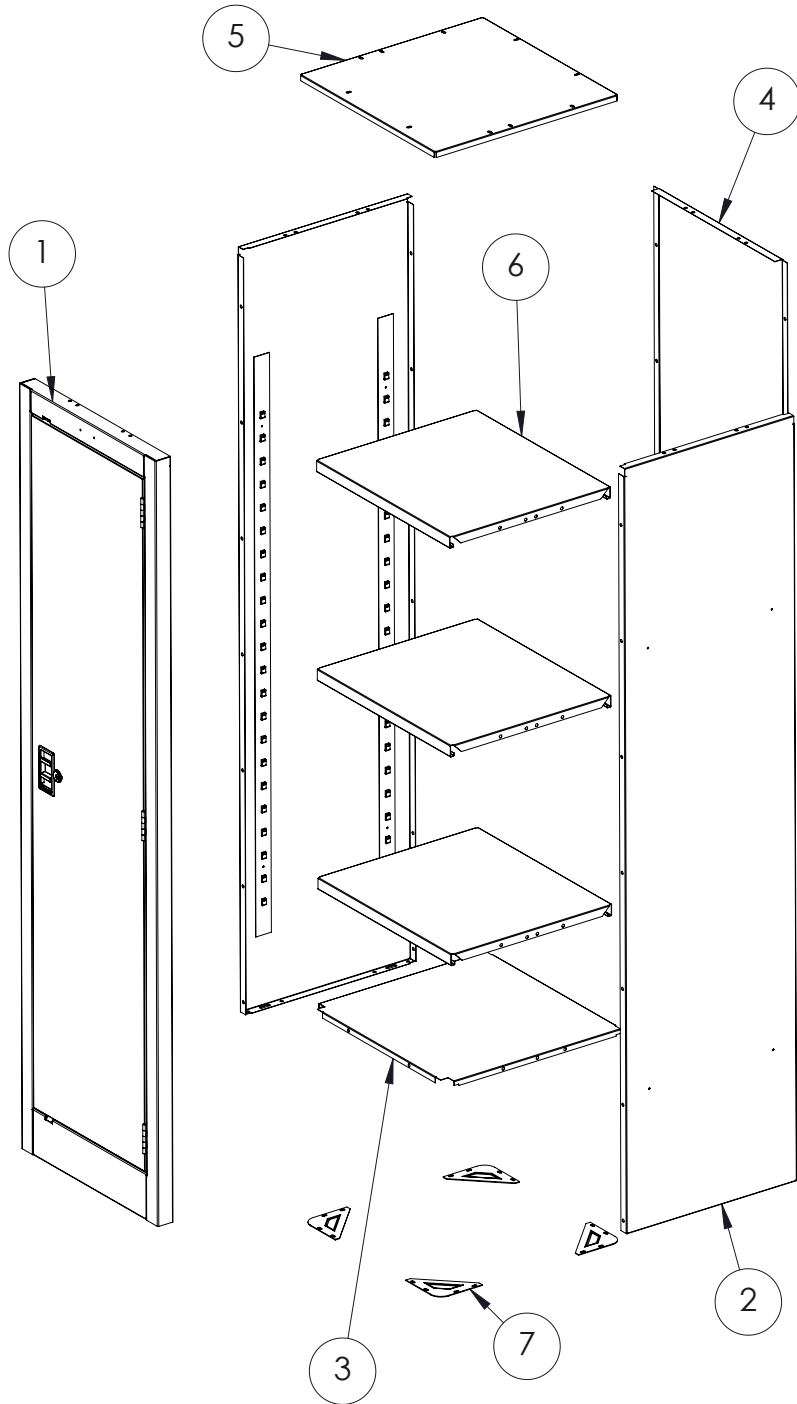

ITEM NO.	DESCRIPTION	QTY.
1	DOOR AND FRAME ASSEMBLY	1
2	SIDE PANEL	2
3	BOTTOM SHELF	1
4	BACK PANEL	1
5	TOP PANEL	1
6	ADJUSTABLE SHELF	SEE TABLE
7	FOOT PLATE	4
8	10-24 X 3/8 SLOTLESS SCREW	SEE TABLE
9	10-24 NUT	SEE TABLE

	CABINET SIZE			
	18x18x42	18x18x66	24x18x66	30x15x66
SHELF QTY.	2	3	3	3
SCREW/NUT QTY.	42	54	56	56

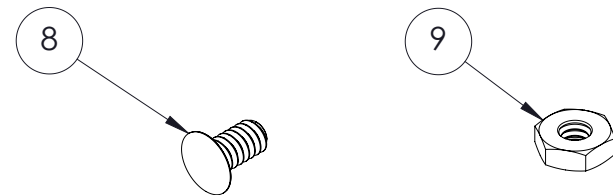

TOOLS REQUIRED:
3/8" WRENCH



NOTE: FINGER TIGHTEN ALL BOLTS UNTIL THE LAST STEP.

1. Place back panel on a protected surface with flanges facing up and the bottom shelf clip towards the bottom.
2. Attach sides panels (2) to the back panel (1) with the flanges under the back panel and the shelf lances point up.

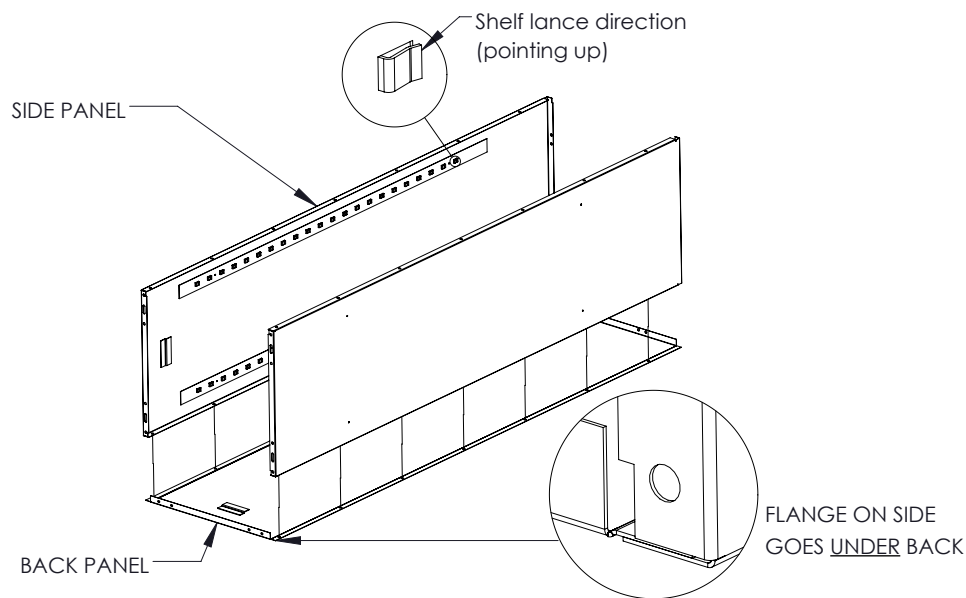

3. Insert shelves (3) at your desired levels in order to keep the side panels (2) together before installing the top.

Note: In order to place the shelves, you must first tilt the shelf slightly to the left or the right before inserting into the unit. Push shelf down into shelf lance to keep in place.

4. Attach top to unit. Make sure flanges on sides (2) and back (1) go outside the top. Bolt to sides (2) and back (1).

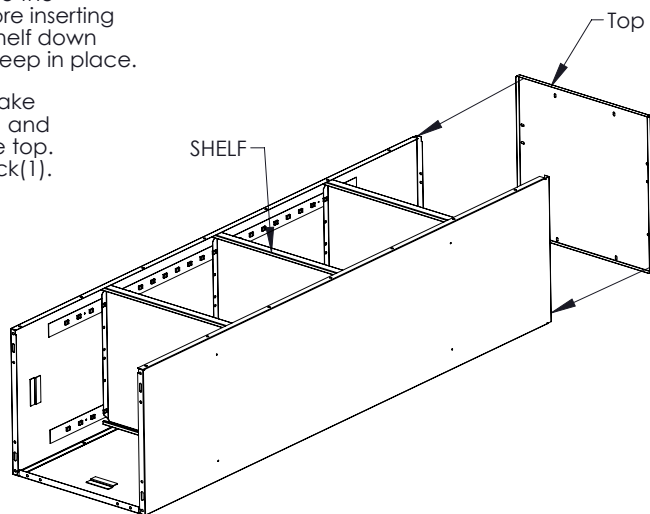

5. Bolt door/frame assembly to the sides (2) and the top (1).

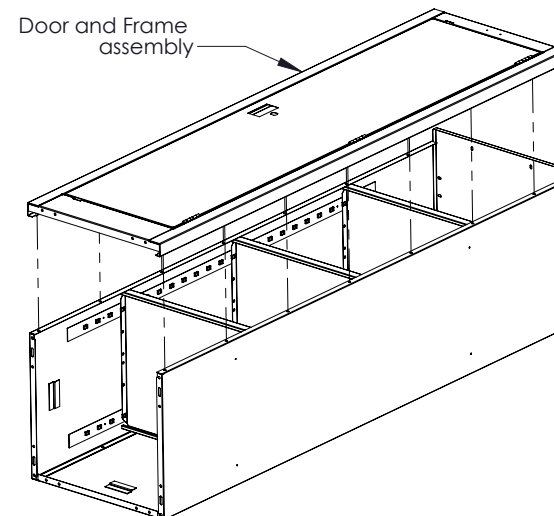

6. Insert bottom from inside of the cabinet, until it seats on the side and back shelf clips. Bolt bottom to the door/frame assembly.

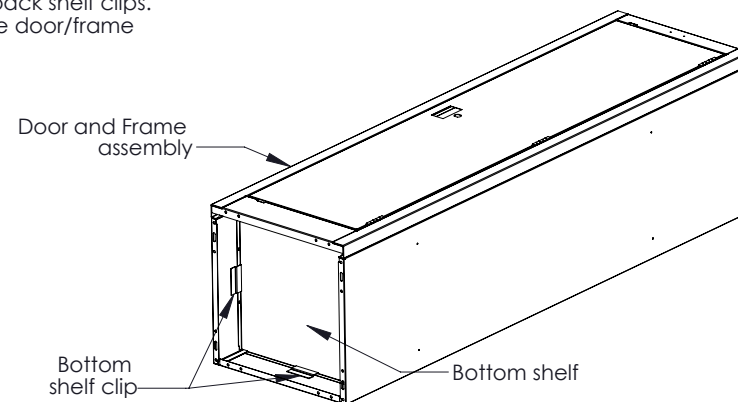

7. Bolt foot plates (4) to the bottom of the cabinet

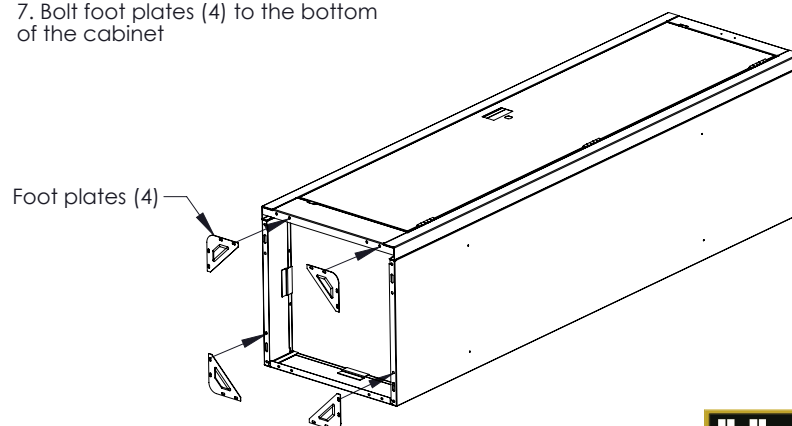

8. Set cabinet upright and tighten all nuts and bolts

Hallowell®

SA4071